

# Motor Assembly Replacement Instructions

## ⚠ WARNING

To prevent possible **SERIOUS INJURY** or **DEATH** from electrocution, disconnect **ALL** electric and battery power **BEFORE** performing **ANY** service or maintenance.

## CAUTION

The garage door **MUST** be in fully closed position during installation.

### INSTALLATION

1. Close the garage door and disconnect power to opener.
2. Place an open-end wrench on the square end of the spring nut, loosen nut to release the belt tension (Figure 1).
3. Remove light lens by gently pressing on the upper corners of the lens to disengage tabs. Remove the two cover screws. Slide cover forward to remove (Figure 2).
4. Remove the belt cap retainer on top of opener by removing the three screws that secure it (Figure 3). Remove the belt from the sprocket. Position the trolley at the center of the rail. Using belt, manually position at center of rail.
5. Use screw driver to remove C-clip from motor shaft. Then slide the sprocket off motor shaft (Figure 3).
6. Disconnect both the high and low voltage wiring harness from the motor. The existing high voltage harness is not used and should be discarded (Figure 4). The replacement motor has an integrated high voltage harness.
7. Remove the motor by loosening the three bolts and washers on the top of the opener (Figure 3).
8. Reverse steps 3 through 7 to reassemble. When reconnecting the wire harness, be sure the tabs on the wire harness are facing the end panel, not the logic board (Figure 5).
9. Reset the belt tension by tightening the spring nut by hand. Place an open end wrench on the square end of the spring nut and tighten clockwise until spring is compressed to 1-1/4" (3.18 cm). This sets the spring to optimum tension. Belt may slip off sprocket if belt is too loose. If belt does slip, reset belt and re-tighten spring nut by turning nut clockwise an additional 1/2 turn. **Do NOT over tighten belt** (Figure 6).
10. Reconnect power to opener.

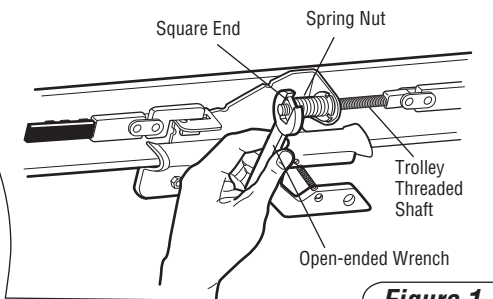
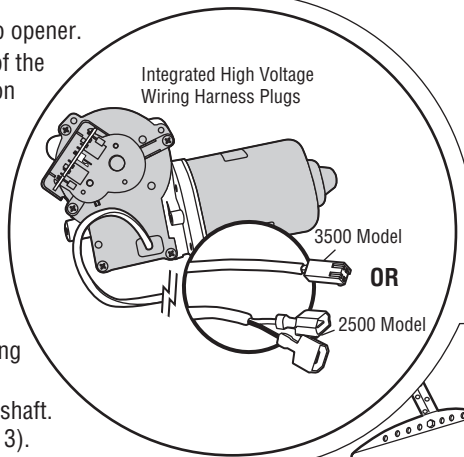

Figure 1

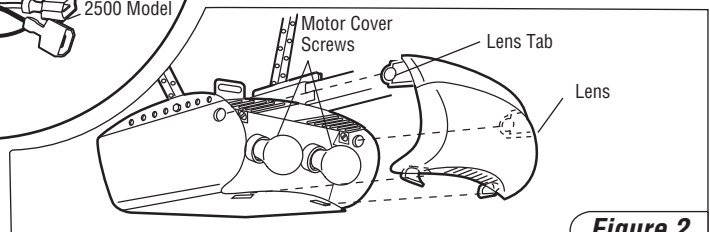

Figure 2

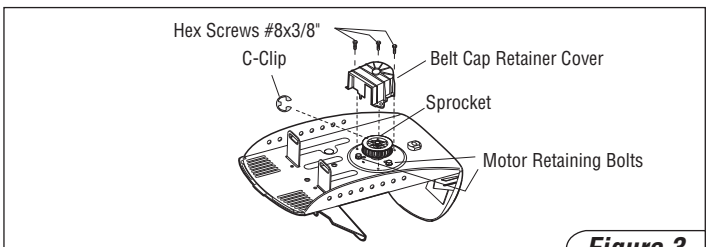

Figure 3

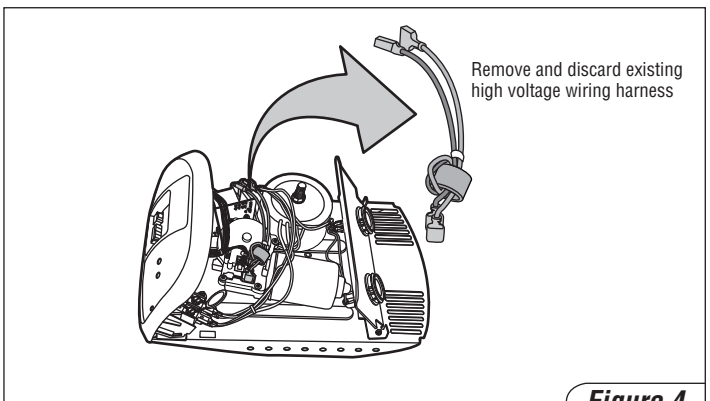

Figure 4

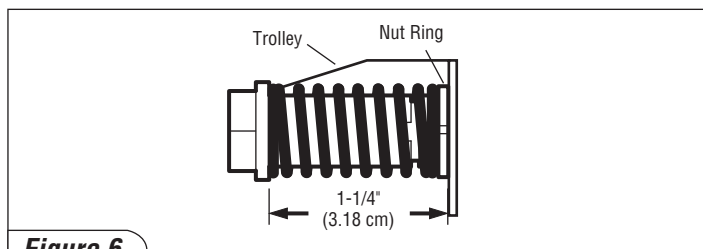

Figure 6

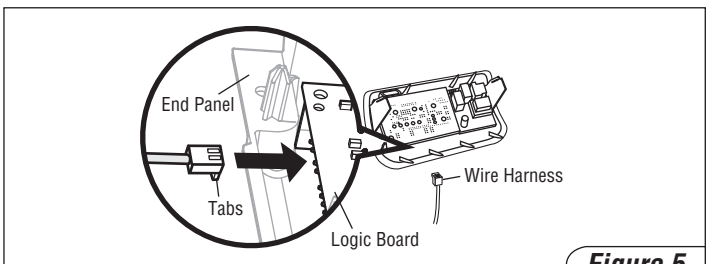

Figure 5

***HOW TO ORDER  
REPAIR PARTS***

**DEVANCO CANADA**

19192 HAY ROAD, UNIT Q  
SUMMERSTOWN, ON K0C 2E0

TOLL FREE: 855-931-3334

[www.devancocanada.com](http://www.devancocanada.com)

**WHEN ORDERING REPAIR PARTS  
PLEASE SUPPLY THE  
FOLLOWING INFORMATION:**

- ✓ PART NUMBER
- ✓ DESCRIPTION
- ✓ MODEL NUMBER