

# SensingEdge

## **Applications**

- **Sectional Doors**
- **Scissor Lifts**
- **Conveyors**
- **Presses**

## **About the ME117...**

This pressure sensitive electric edge can be adapted to suit a wide variety of applications. When touch activated, the ME117 sends an immediate electrical signal to controls to stop and/or reverse operations. With appropriate mounting channel, this edge will fit nearly all doors from 1" to 2" thick. A variety of mounting channels are available for easy installation on machinery applications.



## **OPTIONS:**

- Color: Black
- 4 wire fail-safe configuration or 2 Wire Terminated Edge
- Coil Cord attached
- Retracting Reel
- 4 wire fail-safe Control Panel (MFSC-100)
- 4 wire fail-safe intrinsically safe Control Panel (FSIS-35-4)
- Air-Wave (MAW117) Pneumatic (MEP117)

## **TECHNICAL SPECIFICATIONS:**

Color:	Black
Length:	per specification to nearest 1/4
Lead Wire:	SJTO, 22 gauge universal
Sensitivity:	nominal 8-10 psi
Electrical Diagram:	2 wire /4wire N.O. configuration 2 wire Terminated configuration
Electrical (Max.):	24 volt AC or DC, 1/2 amp
Mechanical Diagram:	See drawings on reverse side
Contact Element:	Alumaglas®
Materials:	Flexible PVC
Mounting Channel:	Rigid PVC/UPVC
Temperature Range:	-30°F to +155°F
Wire Outlet Location:	Universal

## **FUNCTIONAL BENEFITS:**

- Touch Sensitive signalling
- Easy to Install
- Stock sizes available for same day shipment
- Mounts vertically or horizontally

**For more information, please visit [www.devancocanada.com](http://www.devancocanada.com)  
or call toll free at 855-931-3334**



**Model # ME117**

# ***SensingEdge***

## **Installation**

Slide the ME117 Sensing Edge into proper channel. To attach mounting channel, place in desired location. Drill 1/8" holes through channel and into mounting surface. Secure with screws.

**Note:** For safe operation, use a maximum 24 volt, 1/2 amp AC or DC power.

## **Care of the ME117. . .**

Minimal care is required for the ME117 since it is manufactured with only the most durable materials and the highest quality control standards. However, Sensing Edges must be examined once per month for cuts or punctures which could damage internal components. With the Sensing Edge attached and the door open place a 1" thick wood block on the floor in the door's path at approximately the center of the door. Activate the opener. The door opener must reverse and open the door when it comes in contact with the wood. If it does not, a qualified technician must adjust, repair, or replace the necessary parts. Check wiring to be sure connections are secure. Check reversing mechanism often to assure integrity of operations. When properly maintained, the ME117 offers years of trouble free operations.

## **Mounting Channels:**

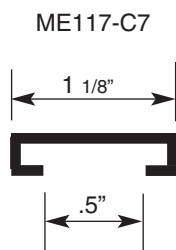

## **Warranty**

We will replace within one year of shipment from our factory, any SensingEdge subject to normal use which is found to have defective materials or workmanship, as determined solely by our factory representative. Replacements will be shipped to you freight collect. This warranty is void where evidence of misuse or abuse is present.

## **Mechanical Diagrams:**

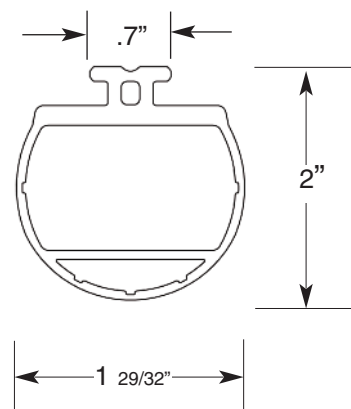

ME117\_Spec\_20130614

**For more information, please visit [www.devancocanada.com](http://www.devancocanada.com)  
or call toll free at 855-931-3334**