

Gate Operator Site Plan

ACCESSORY OVERVIEW

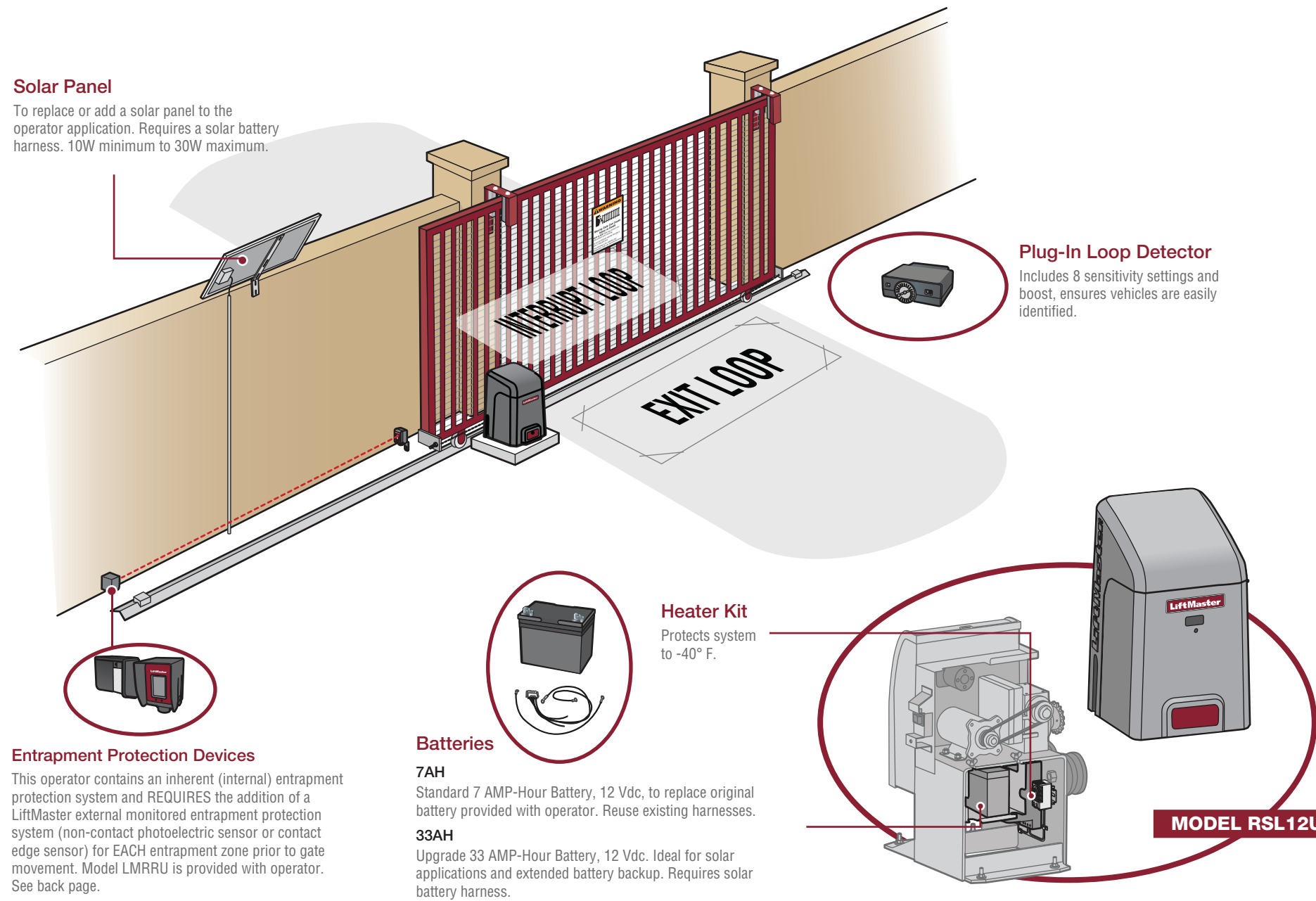

Solar Panel

To replace or add a solar panel to the operator application. Requires a solar battery harness. 10W minimum to 30W maximum.

Plug-In Loop Detector

Includes 8 sensitivity settings and boost, ensures vehicles are easily identified.

Heater Kit

Protects system to -40° F.

Batteries

7AH

Standard 7 AMP-Hour Battery, 12 Vdc, to replace original battery provided with operator. Reuse existing harnesses.

33AH

Upgrade 33 AMP-Hour Battery, 12 Vdc. Ideal for solar applications and extended battery backup. Requires solar battery harness.

Entrapment Protection Devices

This operator contains an inherent (internal) entrapment protection system and **REQUIRES** the addition of a LiftMaster external monitored entrapment protection system (non-contact photoelectric sensor or contact edge sensor) for EACH entrapment zone prior to gate movement. Model LMRRU is provided with operator. See back page.

ORDER SUMMARY

Customer:		Date:
Project:		
Architect/Engineer:		
Contractor:		
Gate Length (ft.):	Gate Weight (lbs.):	
Solar (Y/N):		
Power Source (120 or 240 VAC):		

LiftMaster gate operators comply with UL 325 standards. **IMPORTANT:** To be compliant with UL 325 and industry safety guidelines, LiftMaster qualified monitored external entrapment protection devices such as photoelectric sensors or edge sensors are required to be installed with this operator.

ACCESSORY CHECKLIST

ACCESSORY	MODEL
<input type="checkbox"/> Entrapment Protection Devices	See back page
<input type="checkbox"/> Plug-In Loop Detector	LOOPDETM
<input type="checkbox"/> Universal DIP Single Button Remote Control	811LM
<input type="checkbox"/> Universal DIP Three Button Remote Control	813LM
<input type="checkbox"/> Security+ 2.0® 2-Button Remote Control	892LT
<input type="checkbox"/> Security+ 2.0® 4-Button Remote Control	894LT
<input type="checkbox"/> Wireless Commercial Keypad	KPW250
<input type="checkbox"/> LiftMaster Internet Gateway	828LM
<input type="checkbox"/> 7AH Battery	29-NP712
<input type="checkbox"/> 33AH Batteries	A12330SGLPK
<input type="checkbox"/> Heater Kit	HTR
SOLAR	
<input type="checkbox"/> 10 Watt 12V Solar Panel	SP10W12V
<input type="checkbox"/> 20 Watt 12V Solar Panel	SP20W12V
<input type="checkbox"/> Solar Battery Harness	K94-37236

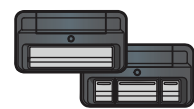

Universal DIP Single-Button and 3-Button Remote Control

These remote controls are ideal for applications such as gated communities or commercial applications requiring a large number of remotes for a common entrance.

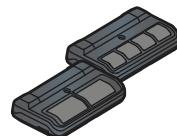

2-Button and 4-Button Security+ 2.0 Learning Remote Controls

These remote controls are ideal for gated communities. One button can control a gate operator and the other(s) can control a garage door. It can also be programmed to different codes and frequencies.



Wireless Commercial Keypad

Security+ 2.0® compatible.



LiftMaster® Internet Gateway

Internet enabled accessory which connects to the computer and allows you to monitor and control gate operators and lighting accessories enabled by MyQ® technology.

For more information:
www.devancocanada.com
or call toll free at 855-931-3334

GATE CONSTRUCTION & SITE PREPARATION

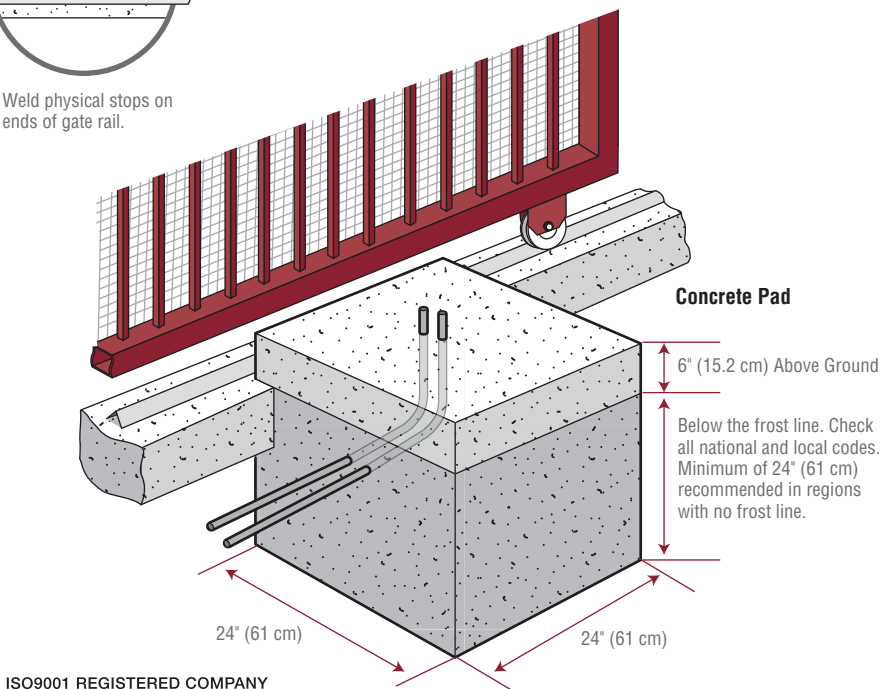
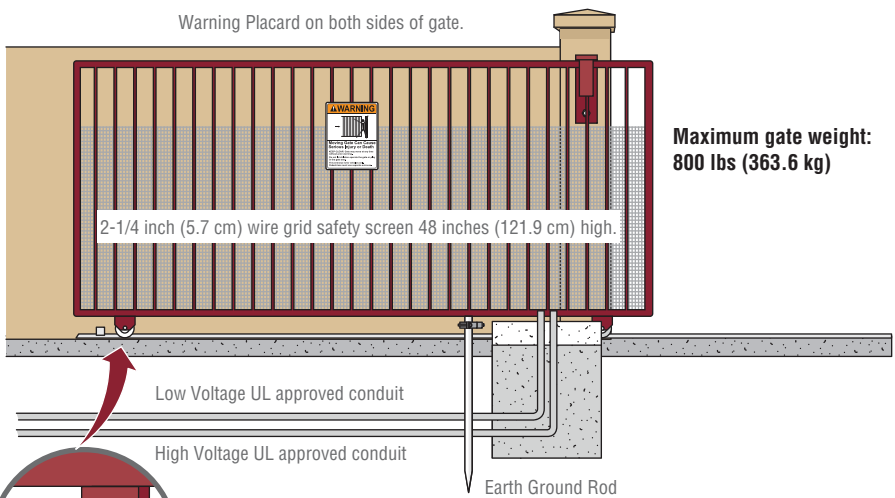
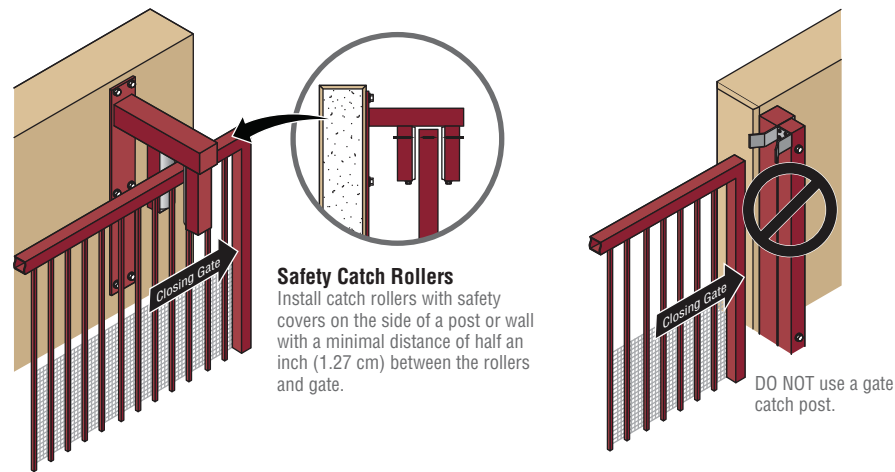

INSTALLATION OVERVIEW

OPERATOR DIMENSIONS

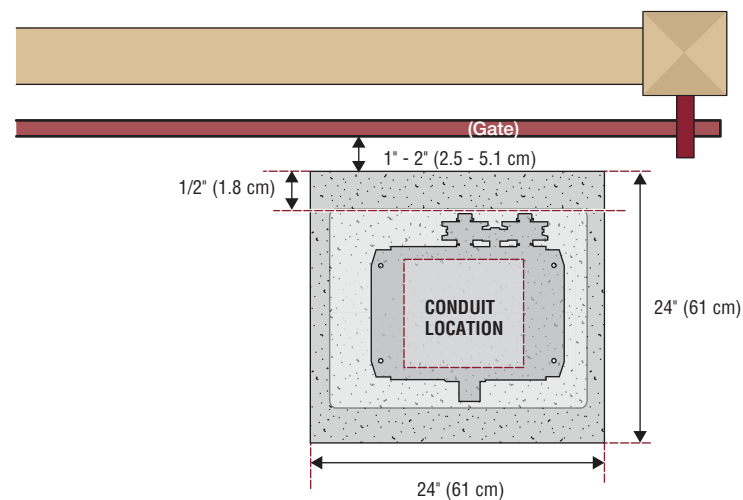
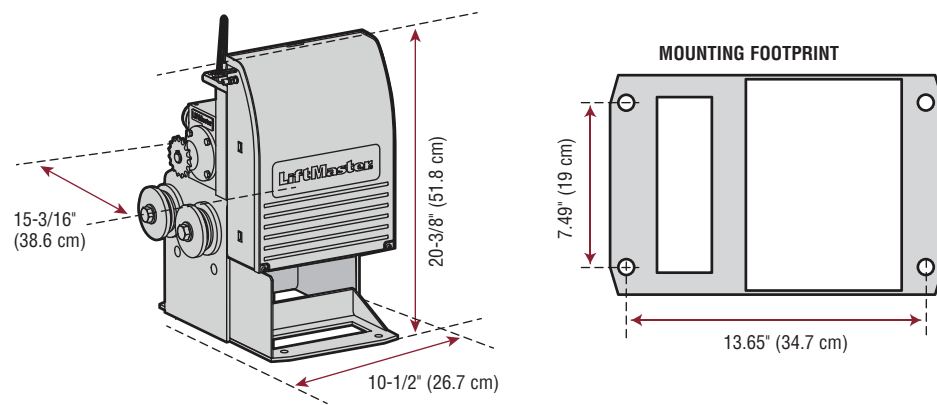

STANDARD DUAL GATE INSTALLATION

OPERATOR POWER SOURCE					
Wire Gauge	EXTERNAL PLUG-IN TRANSFORMER (24 VAC)		Wire Gauge	DIRECT PLUG-IN TRANSFORMER (120 VAC)	
18	150 feet (46 m)		14	1150 feet (351 m)	
16	250 feet (76 m)		12	1850 feet (564 m)	
14	400 feet (122 m)		10	2950 feet (899 m)	
12	600 feet (183 m)				
10	1,000 feet (305 m)				

NOTE: Use copper conductors ONLY.

NOTE: Wired connection in a dual gate setup is optional. Operators can be setup for wireless dual gate communication.

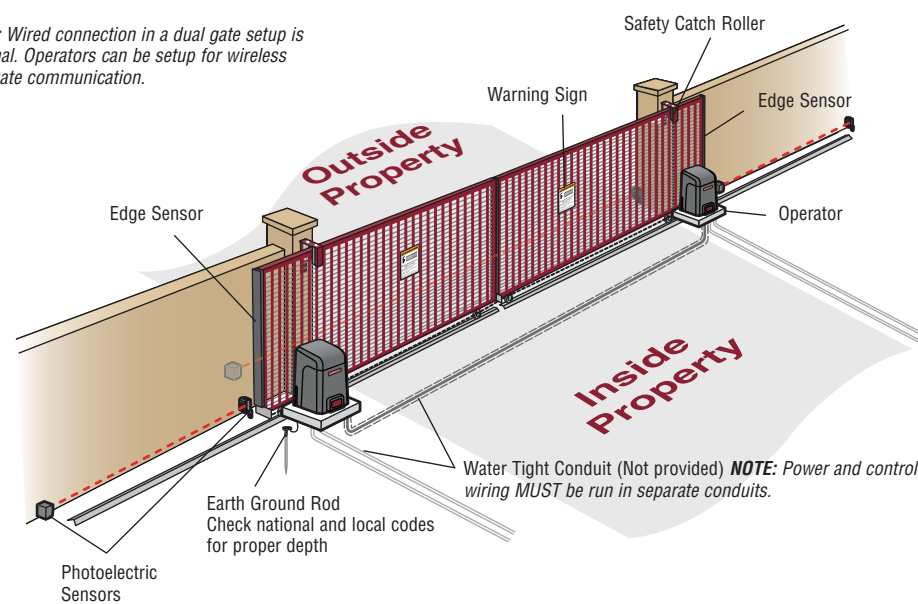

ENTRAPMENT PROTECTION

This operator contains an inherent (internal) entrapment protection system and **REQUIRES** the addition of a LiftMaster external monitored entrapment protection system (non-contact photoelectric sensor or contact edge sensor) for EACH entrapment zone prior to gate movement. An entrapment zone is every location or point of contact where a person can become entrapped between a moving gate and a stationary object. Your application may contain one or many entrapment zones. System includes three monitored entrapment protection inputs capable of covering all entrapment zones (and a total of six inputs with the optional expansion board). Use only LiftMaster approved entrapment protection devices.

NON-CONTACT SENSORS

- Model LMTBU
LiftMaster Monitored Through Beam Photoelectric Sensor
- Model LMRRU
LiftMaster Monitored Retro-Reflective Photoelectric Sensor
NOTE: LMRRU is provided with the operator
- Model CPS-UN4
LiftMaster Commercial Protector System®

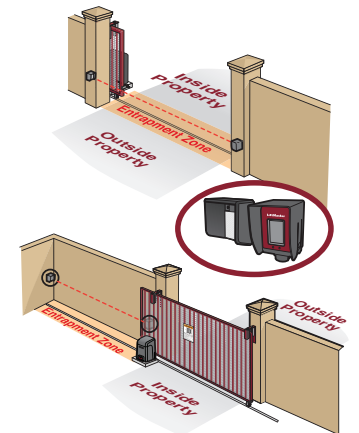

CONTACT SENSORS (EDGE SENSORS)

- Model LMWEKITU
LiftMaster Monitored Wireless Edge Kit (Transmitter and Receiver)
- Model LMWETXU
LiftMaster Monitored Wireless Edge Transmitter
- Model L50
Large Profile Monitored Edge (82 ft. roll)
- Model L50E
Large Profile Ends Kit (pair, pack of 10)
- Model L50CHP
Channel for both Large and Small Profiles - PVC (8 ft., pack of 10)
- Model L50CHAL
Channel for both Large and Small Profiles - Aluminum (10 ft., pack of 8)
- Model S50
Small Profile Monitored Edge (82 ft. roll)
- Model S50E
Small Profile Ends Kit (pair, pack of 10)
- Models L504AL, L505AL, and L506AL
Large Profile Edge - Aluminum Channel (4 ft, 5 ft, 6 ft)
- Models S504AL, S505AL, and S506AL
Small Profile Edge - Aluminum Channel (4 ft, 5 ft, 6 ft)
- Model ETOOL
Edge Cutting Tool
- Models WS4, WS5, and WS6
Wraparound Square Monitored Edge (4 ft, 5 ft, 6 ft)
- Models WR4, WR5, and WR6
Wraparound Round Monitored Edge (4 ft, 5 ft, 6 ft)

