

DR2

DIGITAL RECEIVER

Code Setting Instructions

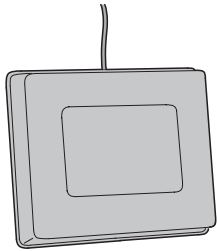

For more information:
www.devancocanada.com
or call toll free at 855-931-3334

Linear

DESCRIPTION: The Delta-3 DR-2 digital receiver is a two-channel wireless radio control designed for use with automatic garage/gate operators and access control systems. The receiver can be activated by any of the Delta-3 format transmitters. **Receivers must be mounted at least 8 feet apart.**

The Delta-3 radio format provides 256 different digital codes. The codes are set using the 8-position coding switches in the units.

*** CAUTION: All transmitters and receivers should be recoded by the installer prior to operation.**

In order to avoid the possibility of duplicating codes in adjacent systems, factory set codes should not be used. In addition, among the valid codes available, four others should not be used. These include: all keys set ON or OFF and keys set alternating ON/OFF. Activate each transmitter to test the equipment.

WARNING! BE SURE DOOR OR GATE AREAS ARE CLEAR OF OBSTRUCTIONS

STEP 1 Locate coding switch. Locate the digital coding switch which is recessed in the center of the back of the receiver case. Note that the coding switch has eight keys. The keys are numbered 1 through 8. Key No. 1 is not used for coding the receiver; its function is permanently wired on the circuit board.

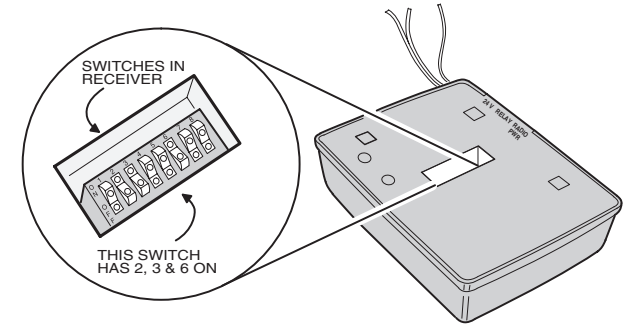

STEP 2 Code the receiver. Pick any combination of ON/ OFF codes and set them on switch keys 2 through 8. Ignore Key 1. The ON position is when the top of the switch is down. The OFF position is when the top of the switch is up and the bottom is down. The code set on Keys 2 through 8 on the receiver must now be matched by all transmitters used in the system.

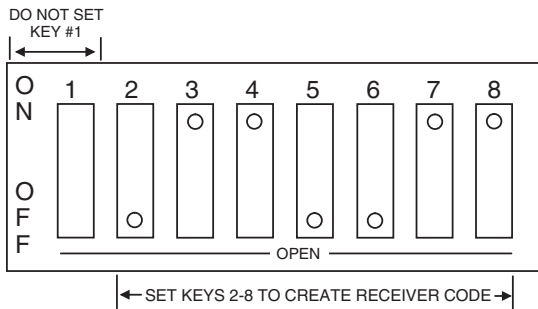

STEP 3 Code the transmitters. Remove the battery access door located on the back of the transmitter case to set transmitter codes. **Keys 2 through 8 must match keys 2 through 8 on the receiver.** To access channel #1, set key #1 to ON. To access channel #2, set key #1 to OFF. Refer to transmitter code set instructions to code multi-button transmitters.

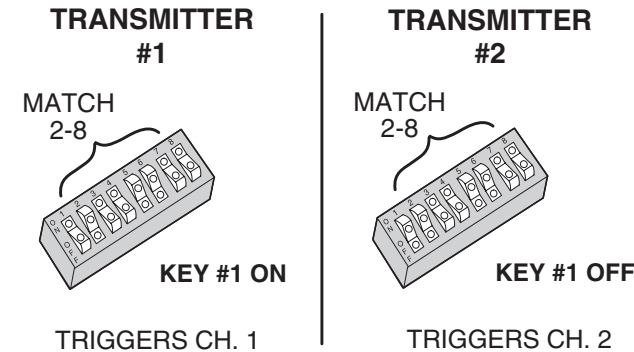

STEP 4A Connecting receiver (using transformer power). A Model 524 transformer can be used to power the receiver when connecting receiver to any operator. Connect as shown, then plug the transformer into a convenient (unswitched) 110 VAC outlet.

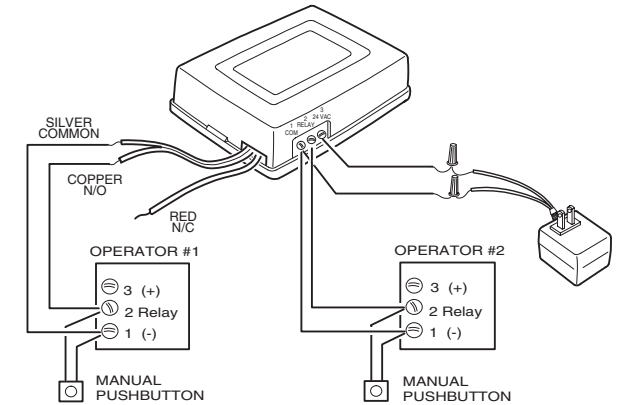

STEP 4B Connecting receiver (using operator power). Connect the receiver to the garage door or gate operator as shown in the diagram. Power will be supplied from the operator.

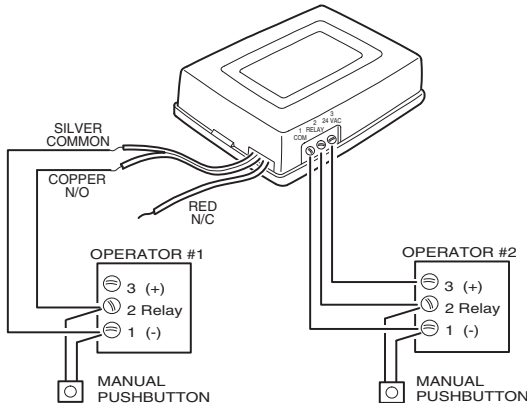

CAUTION:

All transmitters and receivers should be recoded by the installer prior to operation

When Linear's digital transmitters and receivers leave the factory, they are set to predetermined codes — a separate code for each model.

It is not advisable to set a code with all keys ON, OFF, or alternating ON and OFF, because these codes are too easy to duplicate.

LINEAR LIMITED WARRANTY

This product is warranted to the consumer against defects in material and workmanship for one year from the date of purchase. This warranty applies to first retail buyers of new devices. Warrantor will repair, or at its option, replace, any device it finds that requires service under this warranty, and will return the repaired or replaced device to the consumer at the warrantor's cost. For warranty service and shipping instructions contact warrantor at the address shown below. Devices must be sent to warrantor for service at owner's expense. The remedies provided by this warranty are exclusive. Implied warranties under state law are to the one year period of this written warranty. Some states do not allow limitations on how long an implied warranty lasts, so the above limitation may not apply to you. In order to be protected by this warranty, save your proof of purchase and send copy with equipment should repair be required. This warranty gives you specific legal rights, and you may also have other rights which vary from state to state.

All products returned for warranty service require a Return Product Authorization Number (RPA#). Contact Linear Technical Services at 1-800-421-1587 for a time and an RPA# and other important details.

IMPORTANT !!!

Linear radio controls provide a reliable communications link and fill an important need in portable wireless signaling. However, there are some limitations which must be observed.

- * For U.S. installations only: The radios are required to comply with FCC Rules and Regulations as Part 15 devices. As such, they have limited transmitter power and therefore limited range.
- * A receiver cannot respond to more than one transmitted signal at a time and may be blocked by radio signals that occur on or near their operating frequencies, regardless of code settings.
- * Changes or modifications to the device may void FCC compliance.
- * Infrequently used radio links should be tested regularly to protect against undetected interference or fault.
- * A general knowledge of radio and its vagaries should be gained prior to acting as a wholesale distributor or dealer, and these facts should be communicated to the ultimate users.

This device complies with FCC Rules Part 15 and IC Canada Rules and Regulations. Operation is subject to the following two conditions: (1) This device may not cause harmful interference and (2) this device must accept any interference received, including interference that may cause undesired operation.

HOW TO ORDER REPAIR PARTS

DEVANCO CANADA

19192 HAY ROAD, UNIT Q
SUMMERSTOWN, ON K0C 2E0

TOLL FREE: 855-931-3334
www.devancocanada.com

**WHEN ORDERING REPAIR PARTS
PLEASE SUPPLY THE FOLLOWING INFORMATION:**

- ✓ PART NUMBER**
- ✓ DESCRIPTION**
- ✓ MODEL NUMBER**