

CHAMBERLAIN®

**LiftMaster**  
PROFESSIONAL

# LGO LIMIT SHAFT ASSEMBLY REPLACEMENT KIT

K72-16421

**NOTE:** Refer to the owner's manual provided with the operator for all mounting and wiring instructions. You will be required to reset limit nuts after installation.

## REMOVE EXISTING SHAFT

1. Disconnect power to operator.
2. Remove cover.
3. Disassemble master link and remove chain.
4. Remove e-ring, shims and washer from the non-sprocket end of the limit shaft.
5. Slide the limit shaft out of the electrical box. Loosen limit nuts as needed.
6. Remove flanged bearings from the electrical box.

## INSTALL NEW LIMIT SHAFT

To install the new limit shaft, follow the steps outlined above in reverse order, referring to the owner's manual if necessary. Reconnect power to operator.

**For more information:**  
[www.devancocanada.com](http://www.devancocanada.com)  
or call toll free at 855-931-3334

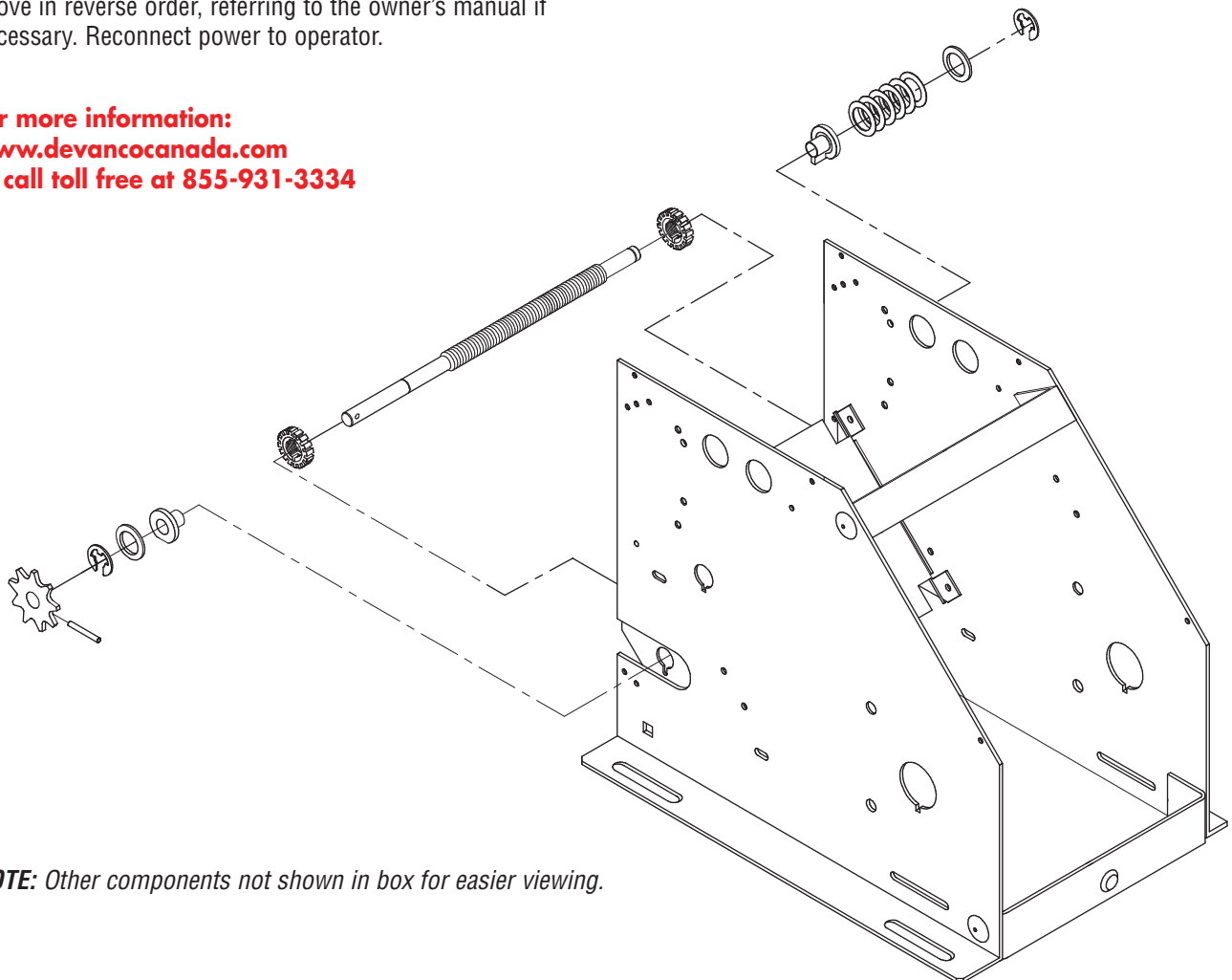

**NOTE:** Other components not shown in box for easier viewing.

## **WARNING**

Disconnect power at the fuse box BEFORE proceeding. If necessary, remove the operator from its mounted position. Operator MUST be properly grounded and connected in accordance with local electrical codes.

**NOTE:** The operator should be on a separate fused line of adequate capacity.

ALL electrical connections MUST be made by a qualified individual.

***HOW TO ORDER  
REPAIR PARTS***

**DEVANCO CANADA**

19192 HAY ROAD, UNIT Q  
SUMMERSTOWN, ON K0C 2E0

TOLL FREE: 855-931-3334

[www.devancocanada.com](http://www.devancocanada.com)

**WHEN ORDERING REPAIR PARTS  
PLEASE SUPPLY THE  
FOLLOWING INFORMATION:**

- ✓ PART NUMBER
- ✓ DESCRIPTION
- ✓ MODEL NUMBER